



# 24th Congress of the International Farm Management Association

RESILIENCE THROUGH INNOVATION

JULY 7-12, 2024

SASKATOON, SASKATCHEWAN





## Table of Contents

Welcome .....	4
Minister’s Message .....	5
IFMA24 Conference Agenda .....	6
Academic and Applied Paper Presentation Schedule .....	9
Research Posters .....	14
Industry Tours.....	15
Accompanying Persons Information .....	17
Next Gens Information.....	18
Maps .....	19
Thanks to the local generosity of:.....	23
Thank you to our sponsors! .....	24

# Welcome

The Organizing Committee for the 24<sup>th</sup> International Farm Management Congress (IFMA24) welcomes you to sunny Saskatoon, Saskatchewan! It has been nearly 10 years since the congress was held in Canada (Quebec in 2015) and ~30 years since the congress was held in western Canada, so we are delighted to have been given the opportunity to host the event in 2024.

Like the congresses before us, we want this week to serve as a forum to exchange ideas, experience and knowledge through presentations and demonstrations. Delegates attending this year come from 20 countries around the globe. Our collective diversity in backgrounds and experiences allows for enlightening discussion on the intersections of agricultural production, agricultural policy, agribusiness, economics, and farm management.

The chosen theme for the Congress is **'Resilience Through Innovation'**. Agriculture faces a multitude of production and business risks; adaptation and innovation are key for farmers/ranchers/growers and agribusiness to remain resilient and profitable.

We are delighted to have 47 contributed papers for oral presentation, three organized sessions and eight posters' presenters sharing their research findings and perspectives.

The field trips on Tuesday and Thursday will give you a glimpse of our agricultural research and production systems, as well as our culture and history.

Throughout this week we encourage you to make new connections and learn what other farm management professionals are doing around the world.

Lastly, I want to recognize the local organizing committee, volunteers, invited presenters, tour stop hosts and sponsors (both cash and in-kind) for making the 24<sup>th</sup> Congress a reality.

Thank you for joining us at IFMA24!

*Eric Micheels*

IFMA24 Congress Chair

# Minister's Message

On behalf of the Government of Saskatchewan, welcome to the International Farm Management Association's Congress.

In Saskatchewan, the agriculture industry is foundational to our province's growing economy. We are excited to share what our producers and agri-businesses have to offer. From high quality crops and animal products to new and innovative technologies, Saskatchewan agriculture is open for businesses, whether you're down the road or across the globe.

Markets across the world recognize Saskatchewan as a great place to do business. which is why in 2023, our agri-food exports exceeded \$20 billion dollars.

To meet and exceed that economic growth, it is important to collaborate with leaders in the farm management industry like yourselves, for you see what works, you make connections between individual producers, suppliers, agribusinesses and others.

This year's congress theme, Resilience Through Innovation, resonates with our agricultural sector and those who work within it. To maintain and grow agricultural economies, it is vital that industries always look ahead, what can be done better, how can we grow, especially in challenging times.

The province's continued emphasis on innovation in the agriculture sector is essential for adapting to a changing global climate and we invest more than \$37 million annually in agriculture research.

This research proves our science-based, sustainable practices are working. Research proves that Saskatchewan producers grow the most sustainable crops in the world, with a track record of maintaining healthy soils, sequestering carbon and minimizing emissions by adopting innovative technology, implementing zero and minimum tillage, diversifying crop rotations, converting annual cropland to perennial cover and investing in research. Our livestock are also key to carbon sequestration while grazing over 20 million acres of native grasslands and tame forages.

Saskatchewan is a great place to have this conference and I hope your time here is fruitful and you take advantage of everything this event has to offer.

We hope to see you again soon,



David Marit,  
Saskatchewan Minister of Agriculture

# IFMA24 Conference Agenda

## Sunday, July 7, 2024

- 1:00 pm Registration Desk Opens (Park Town Hotel Lobby)
- 2:00 pm IFMA Council Meeting (Board Room A; Park Town Hotel)
- 4:00 pm Buses Leave Park Town Hotel area to Wanuskewin Heritage Park
- 5:00 pm ***Supper & Welcome to Treaty 6 Territory, Wanuskewin Heritage Park***

## Monday, July 8, 2024

- 7:15 am Shuttle departs from the Bessborough, then to Park Town over to the University of Saskatchewan Health Sciences Building ***See [Maps](#) for bus loading information***
- 7:45 am Last shuttle pick up
- 8:00 am Coffee/Pastries/Fruit  
Registration (Health Sciences Atrium)

*All plenary sessions in Leslie & Irene Dubé Theatre (Rm 1150 Health Sciences E-Wing, 104 Clinic Place)*

- 8:15 am ***Welcome***  
**Roland Duquette**, Elder-in-Residence, University of Saskatchewan  
**Angela Bedard-Haughn**, Dean, College of Agriculture and Bioresources, University of Saskatchewan  
**Whitney Stobee**, Manager, Business Development, Discover Saskatoon  
**Trevor Atkinson**, President, International Farm Management Association  
**Eric Micheels**, Chair IFMA24  
**Guido van der Hoeven**, Chair, IFMA Professional Development Fund
- 9:00 am ***Lay of the Land – The Canadian Agricultural Economy in Context***  
**J.P. Gervais**, Chief Economist, Farm Credit Canada  
**Jason Newton**, Chief Economist & Head of Market Research, Nutrien
- 10:30 am Coffee Break (Health Sciences Atrium)
- 11:00 am ***Resilient Institutions***  
**Derek Brewin**, Professor, University of Manitoba  
**Wayne Thompson**, Executive Director, Western Grains Research Foundation  
**Adam Carter**, Ministry of Agriculture Strategic Research Program (SRP) Chair in CWRS Wheat, University of Saskatchewan
- 12:30 pm Lunch – Marquis Hall on Campus

- 2:00 pm      ***Resilient Ecosystems***  
**Paul Thoroughgood**, National Manager of Agricultural Sustainability, Ducks Unlimited  
**Darrin Qualman**, Director of Climate Crisis Policy and Action,  
National Farmers Union (Canada)  
**Jenna Sarich**, Technical Consultant, Canadian Roundtable for Sustainable Beef
- 3:15 pm      Coffee Break
- 3:30 pm      ***Contributed Paper Session 1***
- 4:45 pm      ***Contributed Paper Session 2***
- 5:30 pm      ***Poster Session at Agriculture Atrium (51 Campus Drive)***
- 7:00 pm      **Shuttles leave Agriculture Building for hotels**

## **Tuesday, July 9, 2024**

- 9:00 am      Field Trips Depart  
*Buses load on Spadina Crescent and 24<sup>th</sup> Street E (see map)*
- 5:00 pm      Field Trips Return

## **Wednesday, July 10, 2024**

- 7:15 am      Shuttles depart hotels for University of Saskatchewan Health Sciences Building
- 7:45 am      Last shuttle pick up
- 8:00 am      Coffee
- 8:30 am      ***Resilient Farm Businesses***  
**John Cote and Barb Stefanyshyn-Cote**, Black Fox Farm and Distillery  
**Melanie Boldt**, Pine View Farms All Natural Meats  
**Jake Leguee**, Leguee Farms  
**Duane Thompson**, Tee Two Land and Cattle Company
- 10:00 am      Coffee
- 10:30 am      ***Resilient Farm Families***  
**Jack Cocks**, Mt. Nicholas Station, New Zealand  
**Megz Reynolds**, I Got Mind  
**Bob Wilkie**, I Got Mind
- 12:30 pm      Lunch, Marquis Hall
- 2:00 pm      ***Contributed Paper Session 3***

- 3:30 pm Coffee Break
- 3:45 pm **Contributed Paper Session 4**
- 4:45 pm Shuttles Depart for Hotels
- 6:00 pm Buses Depart from Hotels to Western Banquet at the Western Development Museum (Buses return to hotels at 10:00 pm)

### Thursday, July 11, 2024

*Buses load on Spadina Crescent and 24<sup>th</sup> Street E (see map)*

- 8:00 am Irrigation Tour Departs
- 8:40 am Research & Innovation Tour Departs
- 9:00 am Field Trips Depart (*Value-Added, Barley to Beer, Dairy, Livestock – Bison & Beef*)
- 9:30 am Grain & Oilseed Tour Departs
- 5:00 pm Field Trips Return
- 6:00 pm Cocktails at Remail Modern Gallery, River Room (102 Spadina Crescent E)
- 7:00 pm Formal Banquet and IFMA Gala – Remail Modern Gallery, River Room  
*Banquet sponsored by Discover Saskatoon*  
**RetroStatix Band** (9:00 pm – 12:30 am)

### Friday, July 12, 2024

- 8:00 am Coffee
- 8:00 am IFMA Annual General Meeting
- 9:00 am **Resilient Communities**  
**Candace Wasacase**, Panel Host, Kahkewistahaw Economic Management Corporation  
**Cory Alexson**, Nation Councillor, Kahkewistahaw First Nation  
**Justin Delorme**, CEO, Kahkewistahaw Economic Management Corporation  
**Next Gens Leader**
- 10:30 am Coffee
- 11:00 am **Resilient Futures**  
**Mike Frank**, CEO, UPL Limited
- 12:00 pm **David Hughes**, Chair, IFMA 25 – Argentina
- 12:30 pm Closing (Lunch provided in Health Sciences Atrium)
- 2:00 pm IFMA Council Meeting (HLTH 1A03)



# Academic and Applied Paper Presentation Schedule

**Monday, July 8, 2024**

**Contributed Paper Session 1**

**3:30 PM– 4:30 PM**

**The State of Standardization of Farm Records, Accounting, Financial Statements, and Analysis** **HLTH 1150 (Leslie & Irene Dubé Theatre)**

**Session Chair:** Kevin Bernhardt (University of Wisconsin – Platteville; University of Wisconsin Extension)

**Presenters:** Dick Wittman (Wittman Consulting)  
Heather Broughton (Agri-Food Management Excellence Inc.)  
Richard Crane (University of Reading)  
Lachlan Polkinghorne (ProAdvice Pty Ltd)

**Panelists** Grant Bethune (Farm Credit Canada)  
David Hughes (TraulenCo S.A.)

**Livestock Production: Environment and Welfare**

**HLTH GA80**

**Factors Influencing Beef Farmers' Intention to Adopt Semi-Confinement Systems in Mato Grosso Do Sul State, Brazil**

Mariana de Aragão Pereira (Embrapa)

**Economic Consequences of Upgrading Animal Welfare Standards in the European Union on the Example of the Ban on the Use of Farrowing Crates in Pig Production**

Agata Malak-Rawlikowska (Warsaw University of Life Sciences - SGGW)

**Assessing Solutions for Resilient Dairy Farming in Europe**

Abele Kuipers (Wageningen University and Research)

**Ag Policy: Animal Production**

**HLTH GB03**

**Using A Farm Model to Support Agricultural Policy, An Example of Dairy Farms**

Jaka Zgajnar (University of Ljubljana)

**Veal - A Practical (Over)View from Dutch Veal Farmer's Perspective**

Jan Hendrik Mica (Wageningen University and Research)

**Natural Resource Management**

**HLTH GB06**

**Agronomic and Economic Effects of Wetlands on Crop Yields Using Precision Agriculture Data**

Liam Boldt (University of Saskatchewan), Patrick Lloyd-Smith (University of Saskatchewan), Ken Belcher (University of Saskatchewan), John Pattison-Williams (University of Alberta), Gary Bergen (University of Alberta), Katelyn Blechinger (University of Alberta), Ian Paulson (Prairie Agricultural Machinery Institute)

**Push and Pull Factors in Hill Country Farming Change: The Case of Aoteaora New Zealand**

Angela McFetridge (Beef + Lamb NZ), Dr Katherine Dixon (Nature Positive Limited)

**Incorporating Conservation Practices Into Agricultural Leases**

Ray Massey (University of Missouri), Mykel Taylor (Auburn University)

**Ag Policy: Climate**

**HLTH GB10**

**Aligning Renewable Energy Goals with Rural Land Use: Educational Needs for Solar Development Contracts in New York and Maryland**

Elizabeth Thilmany (University of Maryland), Paul Goeringer (University of Maryland)

**Agricultural Production of Biomass for Green Biorefining Can Positively Affect Environment and Climate**

Jakob Vesterlund Olsen (University of Copenhagen)

**Economic Consequences of Sub-Optimal Nitrogen Application in Denmark - Comparing Ex-Ante and Ex-Post Analyses**

Brian Jacobsen (University of Copenhagen)

**Contributed Paper Session 2**

**4:45 PM– 5:45 PM**

**Building Benchmarking Capacity – International Insights**

**HLTH 1150 (Theatre)**

Session Chair: Heather Watson (Farm Management Canada)

**Moderator:** Stephen Duff (Ontario Ministry of Agriculture, Agri-Food and Rural Affairs)

**Presenters:** Agata Malak-Rawlikowska (Warsaw University of Life Sciences – SGGW)

Dick Wittman (Wittman Consulting)

Shea Ferster (MNP)

Mark Verwey (BDO Canada)

**Resilience Through Innovation: Finance**

**HLTH GA80**

**Contribution of Home Gardens to Household Food Security in Umzimvubu Local Municipality, Eastern Cape, South Africa**

Denver Naidoo (University of KwaZulu-Natal)

**Boosting Cocoa Farming Income: The Interaction Effect of Access to Agricultural Extension Services and Farmer Association on Adoption of Approved Pesticides**

Lawrence Oyenpemi (Middle Tennessee State University)

## Agriculture

HLTH GB06

### **Battlefield Tactics for the Management of Zymoseptoria Tritici**

Nicola Cannon (Royal Agricultural University)

### **Deglobalization of the Agriculture?**

Henning Hansen (University of Copenhagen)

### **Rourke's General Farm Practice Change Theory**

David R.S. Rourke (University of Manitoba)

## Big Picture

HLTH GB10

### **The Use of Drones and Comparison with Other Remote Sensing Methods in Crop Production**

Clemens Fuchs (University of Applied Sciences Neubrandenburg), Paul Guetschow (University of Applied Sciences Neubrandenburg)

### **Cereals & Food Security by Sustainable Management: A Half-Century Perspective**

John Wibberley (Royal Agriculture University)

### **AI in Agriculture**

Forbes Elworthy (Craigmore Sustainables)

## **Wednesday, July 10, 2024**

### **Contributed Paper Session 3**

**2:00 PM – 3:30 PM**

### **The State of Farm Business Management Extension – A Global View HLTH 1150 (Theatre)**

**Session Chair:** Heather Watson (Farm Management Canada)

**Presenters:** Pauline Van Nurden (University of Minnesota)

Magnus Stark (SLU)

Tim Brigstocke (Tim Brigstocke Associates)

## Production 2

HLTH GA80

### **Economic Potential of Field Peas as an Alternative to Corn Dried Distillers Grain with Solubles (DDGS) in Beef Heifer Growing Diets**

Jon Biermacher (North Dakota State University)

### **Evaluating the Effect of Environmental Legume Management Options on Crop Establishment and Nitrogen Availability in the Subsequent Barley Crop**

Nicola Cannon (Royal Agricultural University)

### **Corn and Soybean Marketing Strategy Evaluation for Southwest Indiana Farms**

Grant Allyn (Purdue University), James Mintert (Purdue University),

Michael Langemeier (Purdue University)

**Experimental Study and Evaluation of Farm Environmental Monitoring System Based on the Internet of Things – Sudan**

Farid Eltom Elnema (Qingdao Agricultural University - YRDIA)

**Financial Farm Management 1**

**HLTH GB03**

**Long-Term Economic Viability and Farm Succession – Theory to Practice**

Kevin Bernhardt (UW-Madison Division of Extension)

**Applied Risk Analytics: A Series of Case Studies Highlighting Risk Analysis in United States Agriculture**

John Hewlett (University of Wyoming), Jay Parsons (University of Nebraska - Lincoln)

**Colorado Agriculture - A State in Transition**

Jeffrey Tranel (Colorado State University)

**Building Farm Resilience Through the AgPlan Business Planning Software**

Mariah Beverly (University of Minnesota), Pauline Van Nurden (University of Minnesota)

**Leadership: Transition Talk**

**HLTH GB06**

**Building Resilience in Family Businesses – Family Succession**

Lachlan Polkinghorne (Moore Australia)

**Farm Succession: A Communication-First Approach**

Maggie Van Camp (Loft32)

**Developing The Future Farmer: Considering the Farms Accumulated Wealth, History and Succession**

Josee Lemoine (Backswath Management)

**Exploring Youths' Aspirations, Perceptions and Interest Towards Participation Within the Agricultural Sector**

Johannes Henning (University of the Free State)

**Resilience Through Innovation: Environment**

**HLTH GB10**

**Determining the potential gain from improved grazing management decisions in pasture-based dairy production systems**

Clare Leddin (Agriculture Victoria)

**Water Resilience and Change of Water Use Behavior**

Yonas T. Bahta (University of the Free State, Department of Agricultural Economics)

**The Conundrum of Glyphosate: Overused but Indispensable Agronomic Management Tool?**

Jon Wibberley

## **Contributed Paper Session 4**

**3:45 PM– 4:45 PM**

### **Resilience Through Innovation: Producer**

**HLTH GA80**

#### **Redefining Excellence in Agribusiness Advisory: The Role of the Rural Advisor in the Modern World**

James Allen (AgFirst)

#### **Resilience, Producer Sentiment, and Related Farm Characteristics**

Margaret Lippsmeyer (Purdue University), Michael Langemeier (Purdue University),

James Mintert (Purdue University)

#### **Empowering Farmers to Build Resilience**

Jack Cocks (Mt Nicholas Limited)

### **Financial Farm Management 2**

**HLTH GB03**

#### **Investigating The Economic Value of Sex-Sorted Semen in South Africa: A Beef Cattle Example**

Brent Jammer (University of the Free State), Willem Abraham Lombard (University of the Free State)

#### **Profitability Estimates of Using Wine Grape Harvesters in The Western Cape Province of South Africa**

O'Brien Perel (Western Cape Department of Agriculture)

#### **Chasing a Moving Target: Creating a Policy Environment at Sub-National Level**

Dirk Troskie (Western Cape Department of Agriculture)

### **Leadership 2**

**HLTH GB06**

#### **The Role of Professional Advisors in Slowing or Preventing Development of Future Farmers in Canada: What if We're Part of the Problem?**

Patti Durand (Brightrack Consulting)

#### **Fostering a Transformative Shift in Canadian Agriculture by Addressing the Challenges Faced by Farm Women**

Heather Watson (Farm Management Canada)

#### **The Impact of Industry-Based Organizations and Secondary Education Vocational Agriculture Courses on the Farm and Community.**

Mattie Mink (Edmonson County Schools)

### **Ag Policy**

**HLTH GB10**

#### **The Capital Market and Economic Growth in Nigeria**

Grace Evbuomwan (Augustine University)

#### **An Overview of the Impact of Artificial Intelligence on Agricultural Trade and Food Security**

Shida Henneberry (Economic Research Service, U.S. Department of Agriculture)

#### **Lessons from Entering a Regional Trade Area - Long-Term Experience by Danish Agriculture**

Henning Hansen (University of Copenhagen)

# Research Posters

**Monday, July 8, 2024**

**5:30 – 7:00 pm**

**Agriculture Building Atrium (51 Campus Drive)**

## **The Impact of Preferential Trade Policies: A Social Accounting Matrix and Computable General Equilibrium Analysis**

Yonas T. Bahta (University of the Free State)\*

## **Does the Transition Incentive Program Help Beginning Farmers and Ranchers**

Eugene Adjei (University of Saskatchewan)\*

## **Workplace management for farm business growth and female economic participation**

Yukio Kinoshita (Tokyo City University)\*; Kaori Mitsunaga (Mitschan-kobo Co., Ltd.)

## **Maryland Animal Waste Technology Fund Assessment**

Jonathan Moyle (University of Maryland)\*; Elizabeth Thilmany (University of Maryland); Stephanie Lansing (University of Maryland); Shannon Dill (University of Maryland); Jennifer Rhodes (University of Maryland); Jeff Semler (University of Maryland); Rachele Franceschi (University of Maryland); James MacDonald (University of Maryland); Nancy Nunn (University of Maryland); Kathryn Everts (University of Maryland); Priscila Alves (University of Maryland); Marcus Hendricks (University of Maryland); Eric Burnstein (University of Maryland); Mimi Sanford (University of Maryland); Danielle Delp (University of Maryland); Derek Wietelman (University of Maryland)

## **Spatial mapping of forage biomass in grazed dairy pastures at different resolutions and the potential implications for farm management**

Clare Leddin (Agriculture Victoria)\*; Elizabeth Morse-McNabb (Agriculture Victoria); Kevin Smith (Agriculture Victoria); Christie Ho (Agriculture Victoria); Joe Jacobs (Agriculture Victoria)

## **Estimating Corn Production in the U.S. Based on Early July Crop Estimates**

Gregory Ibendahl (Kansas State University)\*

## **Farm Office Live – Resiliency and Innovation in Providing Farm Management Education**

David L. Marrison (The Ohio State University)\*; Peggy Hall (The Ohio State University); Barry Ward (The Ohio State University); Dianne Shoemaker (The Ohio State University); Ben Brown (University of Missouri); Robert Moore (The Ohio State University); Jeff Lewis (The Ohio State University); Wm. Bruce Clevenger (The Ohio State University); Eric Richer (The Ohio State University); Clint Schroeder (The Ohio State University)

## **Empowering Food Entrepreneurs Through Education**

Emily G. Marrison (Ohio State University Extension)\*; Peggy Kirk Hall (Ohio State University Extension); Nicole Arnold (Ohio State University Extension); Garth Ruff (Ohio State University Extension)

# Industry Tours

**(9:00 am buses depart unless otherwise noted)**

**Tuesday, July 9, 2024**

- A. Barley to Beer
  - a. Barley Breeder Plots (Dr. Aaron Beattie)
  - b. Maker's Malt
  - c. IntelliYeast
  - d. 9 Mile Legacy Brewery
  
- B. Value Added Agriculture
  - a. Black Fox Farm and Distillery
  - b. Farm 140
  - c. Twin Peaks Creamery
  
- C. Livestock – People and Poultry
  - a. Riverview Colony
  - b. Star Egg
  - c. Crossmount Cider Company
  
- D. Dairy
  - a. Rayner Dairy (University of Saskatchewan)
  - b. Willow Mills
  - c. MarFay Farms (Merlis Wiebe)
  - d. Twin Peaks Creamery
  
- E. Grains and Oilseeds (*Tour sponsored by Sask Soil Conservation Association*)
  - a. AgInMotion
  - b. Lance Walker Farms
  - c. Ingredient
  
- F. Research and Innovation
  - a. AgInMotion
  - b. Novozymes
  - c. Canadian Light Source

## Thursday, July 11, 2024

- A. Barley to Beer
  - a. Seager Wheeler
  - b. Maker's Malt
  - c. IntelliYeast
  - d. 9 Mile Legacy Brewery
  
- B. Value Added Agriculture
  - a. Black Fox Farm and Distillery
  - b. Farm 140
  - c. Twin Peaks Creamery
  
- C. Livestock – Bison and Beef
  - a. Native Hoofstock Centre
  - b. Livestock and Forage Centre of Excellence
  - c. Devin & Holly Sparrow
  - d. Rivendale Cattle Company (Davey Family)
  
- D. Dairy
  - a. Rayner Dairy (University of Saskatchewan)
  - b. Twin Peaks Creamery
  - c. Hyljon Holsteins (Patrick Hylkema)
  - d. Prairie West Dairies (Derek Westeringh)
  
- E. Grains and Oilseeds **(Departs at 9:30 am)**
  - a. Ag-Quest
  - b. JRG Farms (Josh Lade)
  - c. Grains Innovation Lab
  
- F. Research and Innovation **(Departs at 8:40 am)**
  - a. Canadian Centre for Rural and Agricultural Health
  - b. Canadian Light Source
  - c. Novozymes
  - d. Quantum Genetix
  
- G. Irrigation **(Departs at 8:00 am)**
  - a. Lakeshore Tree Farm
  - b. Canada-Saskatchewan Irrigation Diversification Centre



# Accompanying Persons Information

## **Monday, July 8**

Breakfast at Hotel

- 9:00 am Depart Hotels for Berry Barn
- 10:30 am Brunch at Berry Barn
- 11:30 am Depart for Batoche
- 4:00 pm Seager Wheeler Farm (pie and ice cream)
- 5:00 pm Return to Hotels

## **Tuesday, July 9**

Choice of Industry Tours (see page 16 for details; chosen at registration)

## **Wednesday, July 10**

Breakfast at hotel

- 8:30 am Depart Hotels for Road Coffee
- 9:00 am Road Coffee
- 10:30 am Depart for Ukrainian Museum for tour, lunch, bread making
- 1:30 pm Short walk from Ukrainian Museum to Prairie Lily
- 2:00 pm Riverboat cruise on The Prairie Lily
- 3:00 pm Go to SaskMade for shopping
- 4:10 pm Return to Hotels
- 6:00 pm Busses Depart from Hotels to Western Banquet at the Western Development Museum (Busses return to hotels at 10:00 pm)

## **Thursday, July 11**

Choice of Industry Tours (see page 16 for details; chosen at registration)

- 6:00 pm Cocktails at Remai Modern Gallery, River Room
- 7:00 pm Formal Banquet and IFMA Gala – Remai Modern Gallery, River Room  
RetroStatix Band (9:00 pm – 12:30 am)

# Next Gens Information

## Wednesday, July 3

Arrive in Regina

DoubleTree by Hilton Hotel & Conference Centre Regina

Address: 1975 Broad St, Regina, SK S4P 1Y2, Phone: (306) 525-6767

## Thursday, July 4

Regina

8:00 am Breakfast at hotel

9:00 am Cultivator (Connexus Credit Union)

11:00 am National Circle for Indigenous Agriculture & Food

2:00 pm Tour of market garden outside of Regina

3:30 pm Return to Hotel

7:00 pm Saskatchewan Roughriders Football Game

## Friday, July 5

Kahkewistahaw First Nation

9:00 am Depart Hotel for Kahkewistahaw First Nation

11:30 am Arrive at Kahkewistahaw First Nation

Welcome

Presentation by Lands Committee

Team Building Exercise

## Saturday, July 6

Kahkewistahaw First Nation

Overview of Resources and Challenges

Strategic Planning Sessions

## Sunday, July 7

8:00 am Depart Kahkewistahaw First Nation

1:00 pm Arrive in Saskatoon at Conference Hotel

# Maps

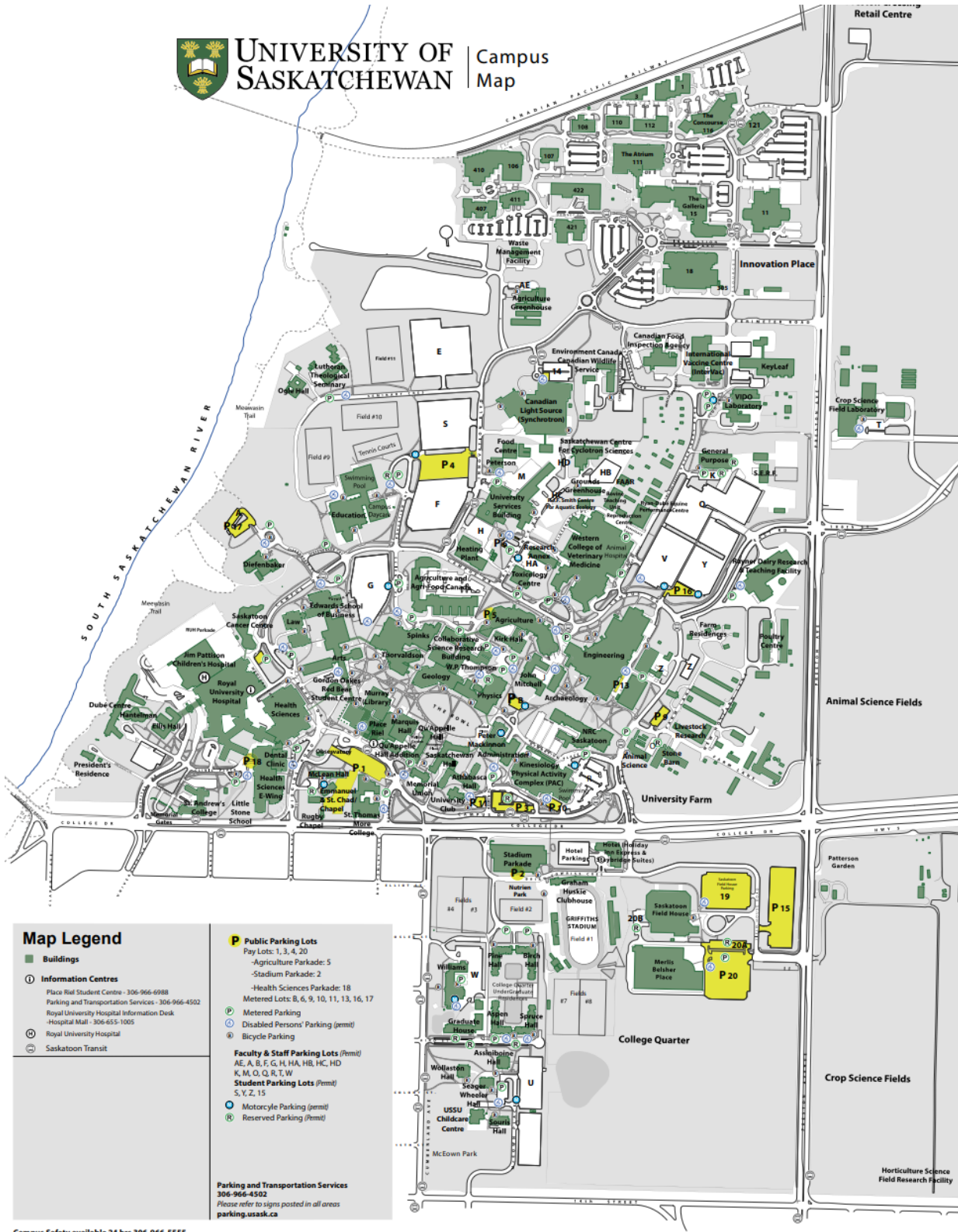

**Map Legend**

- Buildings** (Green square icon)
- Information Centres** (Circle with 'i' icon)
  - Place Riel Student Centre - 306-966-6988
  - Parking and Transportation Services - 306-966-4502
  - Royal University Hospital Information Desk - Hospital Mall - 306-655-1005
  - Royal University Hospital
  - Saskatoon Transit
- Public Parking Lots** (Yellow square icon)
  - Pay Lots: 1, 3, 4, 20
  - Agriculture Parkade: 5
  - Stadium Parkade: 2
  - Health Sciences Parkade: 18
  - Metered Lots: 8, 6, 9, 10, 11, 13, 16, 17
- Metered Parking** (Blue circle with 'P' icon)
- Disabled Persons' Parking (permit)** (Blue circle with 'P' and wheelchair icon)
- Bicycle Parking** (Blue circle with bicycle icon)
- Faculty & Staff Parking Lots (Permit)** (Blue circle with 'P' and 'F' icon)
  - AE, A, B, F, G, H, HA, HB, HC, HD, K, M, O, Q, R, T, W
- Student Parking Lots (Permit)** (Blue circle with 'P' and 'S' icon)
  - S, Y, Z, 15
- Motorcycle Parking (Permit)** (Blue circle with 'P' and motorcycle icon)
- Reserved Parking (Permit)** (Blue circle with 'P' and 'R' icon)

**Parking and Transportation Services**  
306-966-4502  
Please refer to signs posted in all areas  
parking.usask.ca

Campus Safety available 24 hrs 306-966-5555  
December 2019 WWW.USASK.CA

# Health Sciences Building

## E-WING | FIRST FLOOR

**Directory**

**First Floor**

1204	Meeting Room	1430	Research Memory Clinic
1432	Meeting Room	1431	Research Memory Clinic
1434	Tim Hortons	1432	Research Memory Clinic
1436	Lounge	1433	Research Memory Clinic
1438	Shop USask	1434	Research Memory Clinic
1440	Lecture Theatre	1435	Research Memory Clinic
1442	Leslie Irene Dubé Lecture Theatre	1436	Research Memory Clinic
1444	Loading Dock	1437	Research Memory Clinic
1446	Canadian Centre for Food and Agricultural Health (CCFAH)	1438	Research Memory Clinic
1448	Research Memory Clinic	1439	Research Memory Clinic
1450	Research Memory Clinic	1440	Research Memory Clinic
1452	Research Memory Clinic	1441	Research Memory Clinic
1454	Research Memory Clinic	1442	Research Memory Clinic
1456	Research Memory Clinic	1443	Research Memory Clinic
1458	Research Memory Clinic	1444	Research Memory Clinic
1460	Research Memory Clinic	1445	Research Memory Clinic
1462	Research Memory Clinic	1446	Research Memory Clinic
1464	Research Memory Clinic	1447	Research Memory Clinic
1466	Research Memory Clinic	1448	Research Memory Clinic
1468	Research Memory Clinic	1449	Research Memory Clinic
1470	Research Memory Clinic	1450	Research Memory Clinic
1472	Granite Room	1451	Research Memory Clinic
1474	Research Memory Clinic	1452	Research Memory Clinic
1476	Research Memory Clinic	1453	Research Memory Clinic
1478	Research Memory Clinic	1454	Research Memory Clinic
1480	Research Memory Clinic	1455	Research Memory Clinic
1482	Research Memory Clinic	1456	Research Memory Clinic
1484	Research Memory Clinic	1457	Research Memory Clinic
1486	Research Memory Clinic	1458	Research Memory Clinic
1488	Research Memory Clinic	1459	Research Memory Clinic
1490	Research Memory Clinic	1460	Research Memory Clinic
1492	Research Memory Clinic	1461	Research Memory Clinic
1494	Research Memory Clinic	1462	Research Memory Clinic
1496	Research Memory Clinic	1463	Research Memory Clinic
1498	Research Memory Clinic	1464	Research Memory Clinic
1500	Research Memory Clinic	1465	Research Memory Clinic
1502	Research Memory Clinic	1466	Research Memory Clinic
1504	Research Memory Clinic	1467	Research Memory Clinic
1506	Research Memory Clinic	1468	Research Memory Clinic
1508	Research Memory Clinic	1469	Research Memory Clinic
1510	Research Memory Clinic	1470	Research Memory Clinic
1512	Research Memory Clinic	1471	Research Memory Clinic
1514	Research Memory Clinic	1472	Research Memory Clinic
1516	Research Memory Clinic	1473	Research Memory Clinic
1518	Research Memory Clinic	1474	Research Memory Clinic
1520	Research Memory Clinic	1475	Research Memory Clinic
1522	Research Memory Clinic	1476	Research Memory Clinic
1524	Research Memory Clinic	1477	Research Memory Clinic
1526	Research Memory Clinic	1478	Research Memory Clinic
1528	Research Memory Clinic	1479	Research Memory Clinic
1530	Research Memory Clinic	1480	Research Memory Clinic
1532	Research Memory Clinic	1481	Research Memory Clinic
1534	Research Memory Clinic	1482	Research Memory Clinic
1536	Research Memory Clinic	1483	Research Memory Clinic
1538	Research Memory Clinic	1484	Research Memory Clinic
1540	Research Memory Clinic	1485	Research Memory Clinic
1542	Research Memory Clinic	1486	Research Memory Clinic
1544	Research Memory Clinic	1487	Research Memory Clinic
1546	Research Memory Clinic	1488	Research Memory Clinic
1548	Research Memory Clinic	1489	Research Memory Clinic
1550	Research Memory Clinic	1490	Research Memory Clinic
1552	Research Memory Clinic	1491	Research Memory Clinic
1554	Research Memory Clinic	1492	Research Memory Clinic
1556	Research Memory Clinic	1493	Research Memory Clinic
1558	Research Memory Clinic	1494	Research Memory Clinic
1560	Research Memory Clinic	1495	Research Memory Clinic
1562	Research Memory Clinic	1496	Research Memory Clinic
1564	Research Memory Clinic	1497	Research Memory Clinic
1566	Research Memory Clinic	1498	Research Memory Clinic
1568	Research Memory Clinic	1499	Research Memory Clinic
1570	Research Memory Clinic	1500	Research Memory Clinic

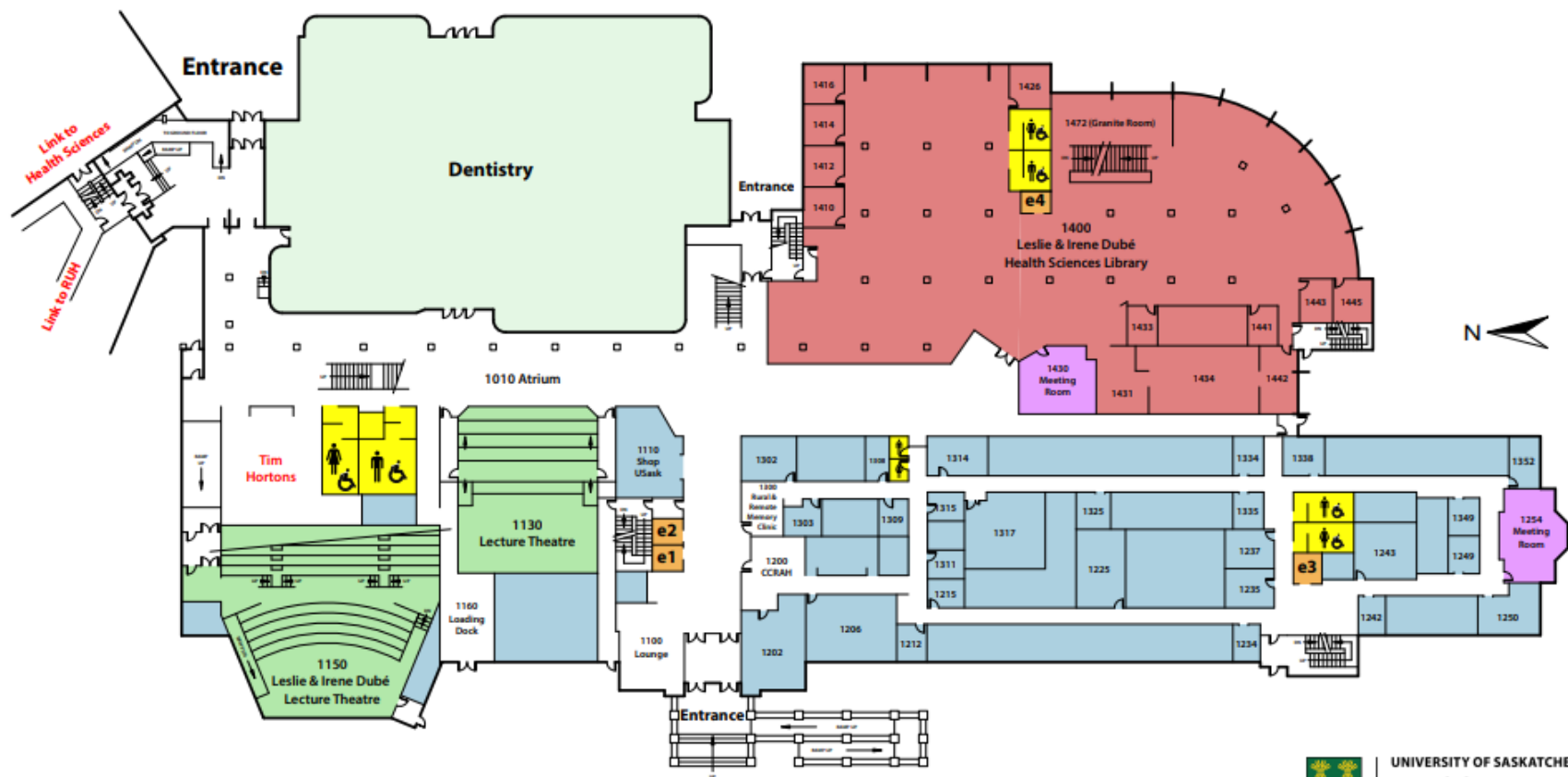
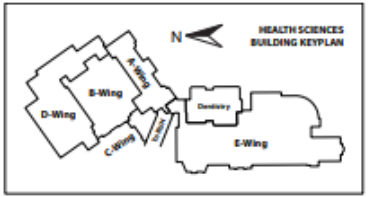



**24TH CONGRESS  
INTERNATIONAL FARM MANAGEMENT  
ASSOCIATION**  
JULY 7-12, 2024  
SASKATOON, SK CANADA

**Locations of reserved  
parking spots on July 9  
(6 spots) & 11 (7 spots)  
for Charlie's Charters  
buses**



We have arranged with the City, Park Town Hotel, and the ImPark Parking lot, to load buses in numerous locations.

Monday, Wednesday, and Fridays we will load buses outside the hotels or in the ImPark lot. On Tuesday & Thursday, we will also be loading all along Spadina Crescent E and 24<sup>th</sup> St East as shown in the map above. We will help you locate your bus.

# Health Sciences Building

A-WING | B-WING | C-WING | D-WING

GROUND FLOOR



### Directory

**Ground Floor**

GA20.14	Meeting Room	e	Elevator
GA20.26	Meeting Room	m	Meeting Rooms
GA70	Computer Lab	r	A-Wing
GA80	Classroom	b	B-Wing
GB03	Lecture Theatre	c	C-Wing
GB06	Lecture Theatre	c	C-Wing
GB10	Classroom	c	C-Wing
B18	(HSSC) Health Sciences Supply Centre	b	B-Wing
GC01	Student Lounge	c	C-Wing
GC10	Meeting Room	c	C-Wing
GD04	Conference Room	d	D-Wing
GD07	Small Atrium	d	D-Wing
GD10	Research Lab	d	D-Wing
GD50	Large Atrium	d	D-Wing
GD80	Loading Dock	d	D-Wing



UNIVERSITY OF SASKATCHEWAN  
**Health Sciences**  
 HEALTHSCIENCES.USASK.CA

## Thanks to the local generosity of:

**Three Farmers Foods** for their donation of the Lentil and Faba beans in your welcome bags. As well as their kind offer of a 15% discount online at:  
<https://threefarmers.ca/discount/IFMA24>



**Shop USASK** for a 10% discount on participating regular-priced merchandise for our attendees, July 8-12 at the E-Wing shop in the Health Sciences Building and their shop located below Marquis Hall.



The offer is only available to IFMA24 delegates wearing their badges.

<https://shop.usask.ca/>

The **TASTE** Hospitality Group has been nice enough to offer 15% off to the restaurants:

**Picaro Cocktails & Tacos** - 101 20th St W A, Saskatoon, SK S7M 0W7

**Cohens Beer Republic** - 101 20th St W, Saskatoon, SK S7M 0W7

**\*\*Wear your badge or state that you're with IFMA for the discount.\*\***



*And lastly, thank you to our volunteers.*

*We could not have seen this through without your help.*

Thank you to our sponsors!

PLATINUM SPONSORS



CLOSING BANQUET SPONSOR

GRAINS & OILSEEDS TOUR SPONSOR



GOLD SPONSORS



IN-KIND SPONSORS

